



NEW
RELEASE
INFORMATION
Vol.82

EXHAUST MANIFOLD

SR20DET Exhaust Manifold

TOMEI Supreme Exhaust System
EXPREME



New Release!
Super Response
Exhaust Manifold!!

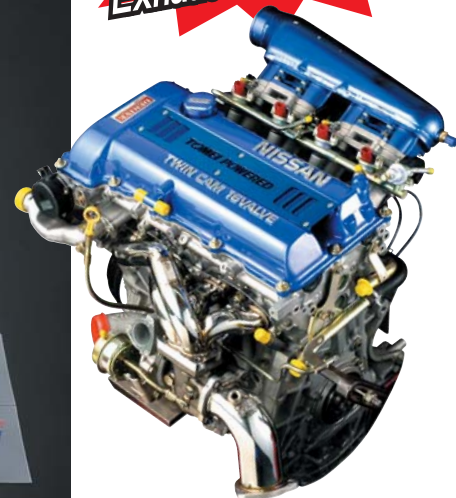

The Ultimate SR Exhaust Manifold Designed by Engine Professionals, TOMEI.

The TOMEI EXPREME products were designed for the purpose of a direct high performance upgrade from the factory setup so that the auxiliaries like the Turbine can be kept in the same factory position. The SR20DET Engine Exhaust Port to the Turbine is very close so if the exhaust manifold was made the same length, the 4th pipe has to be made almost vertically straight. With this type of layout, comparison tests with the new high performance prototype and the original factory design showed that there was no other design that can exceed the original designs performance in all RPM range. The best use for the prototype design was in the high RPM range which is not always used for every driver. So the end conclusion was that the standard design was superior in all round performance. So with that in mind we designed more prototypes similar to the original design and bit by bit made changes until we found the best results possible to give you the Ultimate Bolt on Performance Exhaust Manifold.

■ Application: (R) PS13/S14/S15 SR20DET Powered Cars (ABS OK) ■ Turbine Compatibility: Factory ~ Aftermarket Bolt Ons
※ (R) PS13 requires the outlet/dump pipe to be changed.

■ Kit Contents: Exhaust Manifold, Gaskets, Expeme Thermal Bandage, Bolts, Bolt Smooth Paste, Sticker

■ Material: SUS304 Pipe Diameter: ϕ 42.7 Pipe Thickness: 2mm

MSRP: \$660.00 USD

Part number : 193086

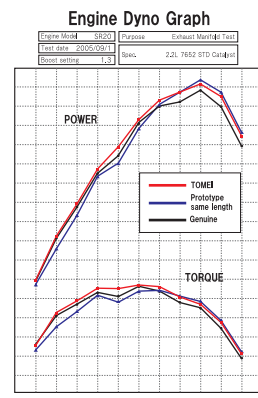

SR20DET Related Development Products



TOMEI Supreme Exhaust System
EXPREME

OUTLET PIPE

Larger internal diameter helped improve exhaust flow efficiency. This helps reduce the secondary exhaust pressure which normally causes power loss, deterioration in response and instable boost pressure.

EAI Compatible Products Out Now!!

Part number	Application	Compatible Manifolds	MSRP
193101	PS13, RPS13 (EAI Compatible)	EXPREME or S14 type	\$220.00 USD
193103	PS13, RPS13 (EAI Compatible)	S13 Genuine or PS13 type	
Part number	Application	Compatible Manifolds	MSRP
193060	PS13, RPS13 (EAI Non Compatible)	Standard, All Aftermarket Bolt On Types	\$220.00 USD
	S14, S15 (Non EAI Equiped Cars)		

※ As EAI is not installed for S14/S15 by default, EAI compatibility is not required.
※ Most aftermarket Exhaust Manifolds are S14 type models.

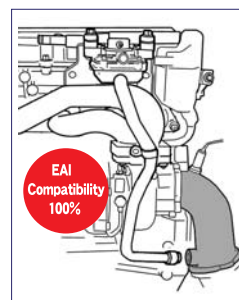

EAI JOINT PIPE

To connect EAI when using EXPREME Exhaust manifold.

■ Compatibility: PS13/RPS13
■ Vehicle Type: Silvia/180SX

MSRP: \$20.00 USD

Part number : 191232



ARMS
TURBO PERFORMANCE

ARMS B7652 Turbine Kit

MSRP: \$2,180.00 USD

Compatibility / Part #: (R) PS13/ 173007 · S14, S15(-00.10)/ 173008 · S15(00.10-)/ 173014

ARMS B8446 Turbine Kit

MSRP: \$2,730.00 USD

Compatibility / Part #: (R) PS13/ 173009 · S14, S15(-00.10)/ 173010 · S15(00.10-)/ 173015

The Turbine is easily controlled by the throttle.



Direct feeling as never felt before...

1. Amazing Turbine Response

Preeminent Turbine response is achieved with a shorter pipe design.

■ TOMEI Exhaust Manifold

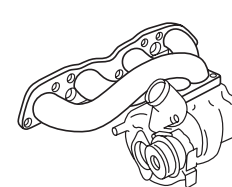

The distance to the turbine is reduced by shortening the pipe outlet to achieve better turbine response.

■ Prototype with equal length design



It sits vertically higher from the exhaust port, and the distance to the turbine is further, which reduces the turbine response.

2. Exhaust pressure rise is prevented even when high RPM, ideal exhaust efficiency is obtained

The TOMEI EXPREME exhaust manifold for SR20 has a partition plate inside the turbine side port, thus the exhaust port is divided into 1st and 4th, 2nd and 3rd. As sequential firing of SR20DET's firing order is 1→3→4→2, the exhaust is discharged from each left and right of partition plate. This helps to reduce exhaust interference which can easily happen with multiple sections merging into one.

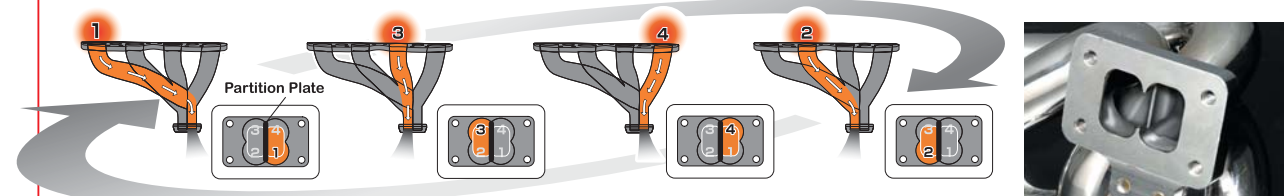

3. Support Bracket Included



This support bracket helps as an added reinforcement.

4. EXPREME Thermal Bandage Included



The bandage is heatproof for temperatures up to 1100°C, heat dissipation is reduced up to 90%. This helps reduce the Intake air & Oil Temperature which helps extract more power from the engine.

5. Street Legal in Japan

Absolutely Compatible with the EAI mechanism and blow by separator [(R)PS13]. EXPREME Thermal Bandage is included in the kit and is street legal in Japan.

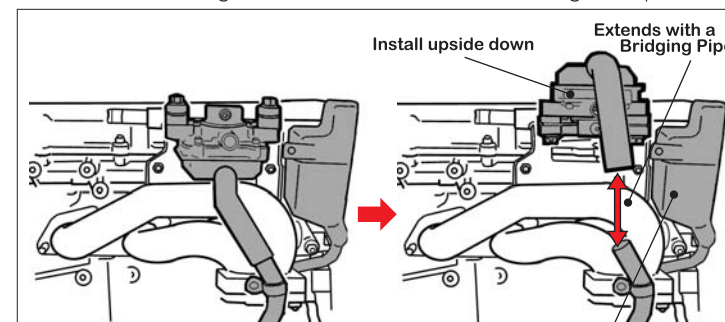

Blow by separator can be fitted too.
Complys to Japans Roads road worthy inspection.

You can retain the original position of the EAI the EAI control valve unit just by fitting it upside down and connecting an extension pipe.



Simple installation with the TOMEI turbine outlet pipe. Sold separately (EAI Compatible type) & Tomei EAI bridging pipe.

TOMEI POWERED INC.

1737-3 TSURUMA, MACHIDA-SHI, TOKYO ZIP 194-0004
TEL: +81 42-799-8411 FAX: +81 42-799-7851

株式会社 東名パワード

〒194-0004 東京都町田市鶴間1737-3
URL: www.tomei-p.co.jp

Go to <http://expreme.pro.nu>